

soma

Office furniture for
better acoustics

2020
FURNITURE DESIGN

Vol. 01

2020furnituredesign.co.uk

soma

Soma is a system of acoustic furniture and panels that organizes sound as consistently as it organizes space. Minimal form. Maximum tranquility.

Designed by Broła&Bukowska



Crafted by 2020FD

Crafted with care. Designed for people.

Soma is a collection of office furniture designed from the ground up around people – their senses, emotions, and daily work rhythms. The system of cabinets, panels, wall screens, and desks creates a coherent language of form: soft edges, tactile fabrics, and a consistent, monochromatic palette of finishes structure the space while simultaneously "humanizing" it.

The collection elements smooth out sound reflections where they arise – around desks, in passageways, in meeting areas – supporting concentration, reducing cognitive fatigue,

and building a sense of calm. Focus zones, collaboration spaces, and recovery areas are combined in a single system, and the office becomes a structure that can grow and change with the team's needs.

The Soma collection by **Studio Brola & Bukowska** for **2020 Furniture Design** combines the sensitivity of neurodesign with the craftsmanship of production. These are pieces of furniture that not only organize workspaces but also truly support the people who co-





soma

Acoustic. Inclusive. Modular.



Manifest

Work has many facets. People think, focus, and collaborate in different ways. Our furniture adapts to them—never the other way around.

Sound matters. We incorporate high absorption efficiency into every form to mute reflections where they arise. Less reverberation. Clearer speech. Deeper concentration.

Touch is also important. We choose materials that are equally pleasing to the eye and to the hand – soft where you touch them, pleasantly warm in your field of vision, and durable where they work most intensely.

Spaces change; furniture should keep up. Height-adjustable desks, modular cabinets, mobile dividers, and wall panels allow you to reorganize your space in minutes, not months.

Clarity over noise. Simple forms, disciplined details, and a visual calm that gives priority to people and their ideas.

Design is a tool, not a goal. Everything is subordinated to the work: comfort, concentration, collaboration.

Furniture that listens.



Why Acoustics?

Much needed

Acoustics aren't a "nice-to-have," but a quiet engine of concentration. When reverberation subsides, conversations suddenly become clear, meetings become calmer, and the brain no longer has to work as hard to decipher every sentence. Our furniture conceals porous sound absorbers (LDF boards) within its forms, muting reflections at the source and "tuning" rooms from within instead of merely blocking noise between walls. The result? Shorter reverberation times, improved speech intelligibility, and less cognitive fatigue.

This means more effective teamwork, calmer meetings, less organizational noise, and a space that actually supports company results, rather than just looks good.



One language, many configurations

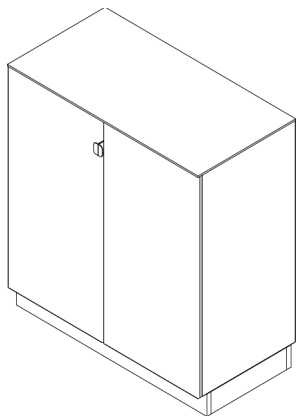

soma pure
acoustic doors and side walls of the furniture

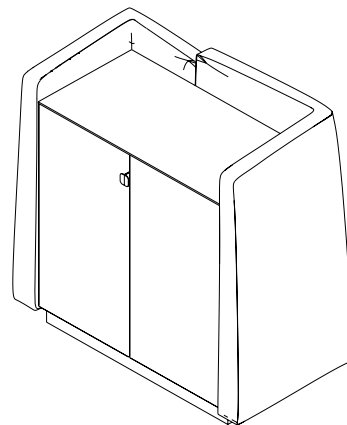

soma shell
acoustic doors and panels around the furniture on three sides for maximum sound insulation





Choose your version

A common grammar of form and detail facilitates interior design – from quiet “me space” to vibrant collaboration zones.

Collection

Storage

STR. 16

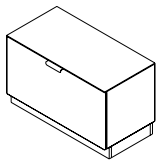

S-01

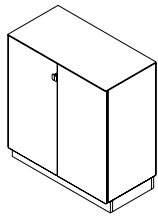

S-02

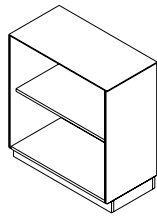

S-03

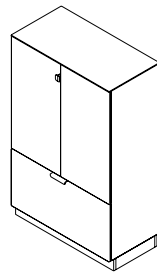

S-04

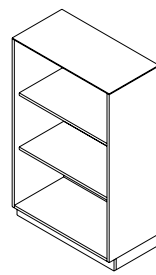

S-05

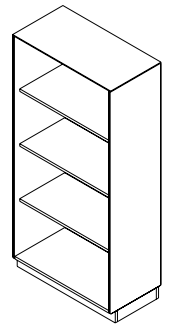

S-06

Storage with panels

STR. 16

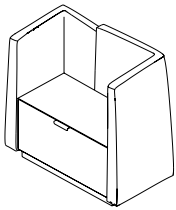

SP-01

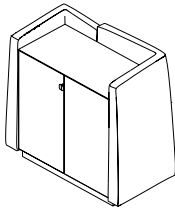

SP-02

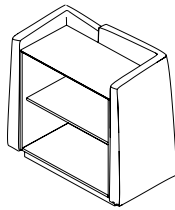

SP-03

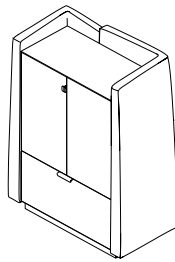

SP-04

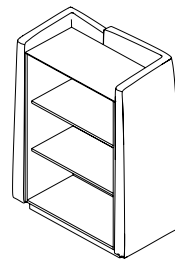

S-05

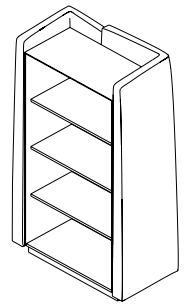

SP-06

Panels

STR. 16

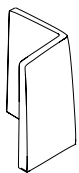

P-01

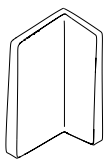

P-02



P-03

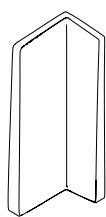

P-04



P-05

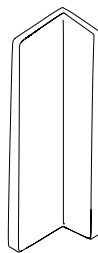

P-06



P-07

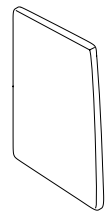

P-08

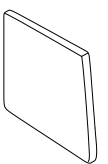

P-09

Wall screens

STR.16

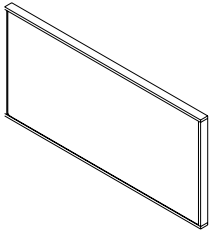

WS-01

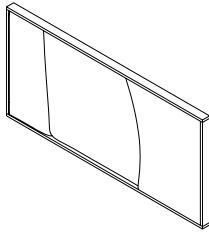

WS-02

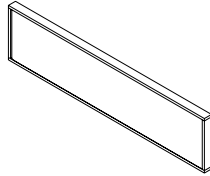

WS-03

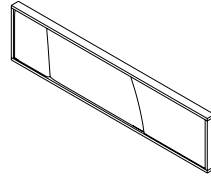

WS-04

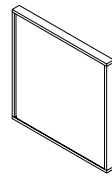

WS-05

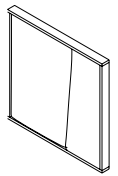

WS-06

Desks

STR.16

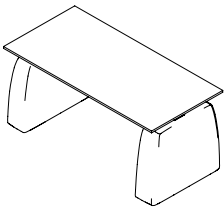

DK-01

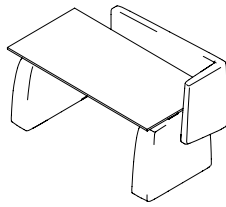

DK-02

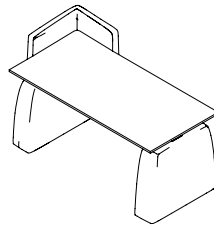

DK-03

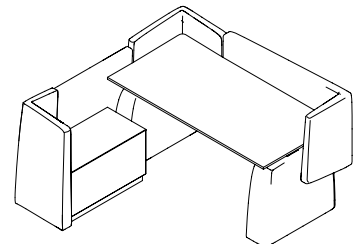

DK-04

Add-ons

Tables

STR.16

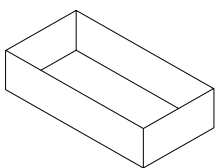

AD-01

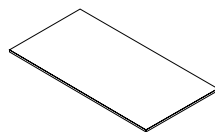

AD-02

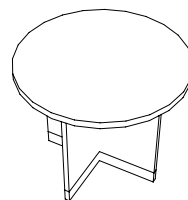

T-01

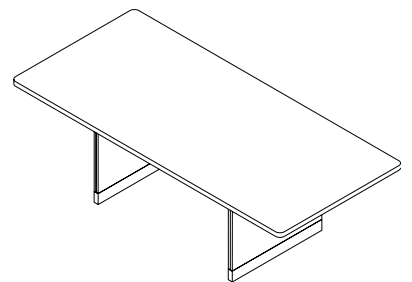

T-02

soma





Storage

storage solutions
with acoustic
properties

SOMA cabinets form a family that can be adapted to almost any office scenario. They are available in open and closed versions, with doors, internal or external drawers, and can be used individually or in longer rows, organizing documents, equipment, and personal belongings. The cabinet sides can be upholstered or made of furniture board, and if necessary, additional acoustic panels can be added to further enhance sound comfort. All modules have one thing in common: upholstered fronts, which introduce a visual softness and, even in the most basic configuration, significantly reduce office reverberation.





mix & match



The **soma** system's components can be freely mixed and matched: various types of cabinets can be combined with panels, housings, and extensions, creating furniture tailored to the needs of a given space. Simple modules can be used to create acoustic "islands" at desks, buffers between work areas, or tall, protective backrooms. The same set can start as a classic storage area and later be expanded with panels and extensions when the office needs greater privacy and improved acoustics without replacing all the equipment.



Storage

cabinet modules for storage and convenient zoning.

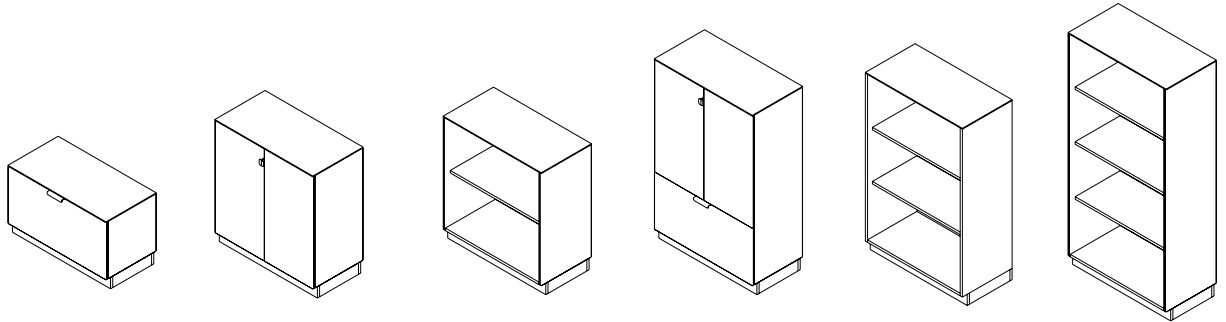

	S-01	S-02	S-03	S-04	S-05	S-06
height	490	880	880	1285	1285	1655
depth	410	410	410	410	410	410
width	800	800	800	800	800	800

interior	drawer	shelves	shelves	drawer and shelves	shelves	shelves
additional elements						

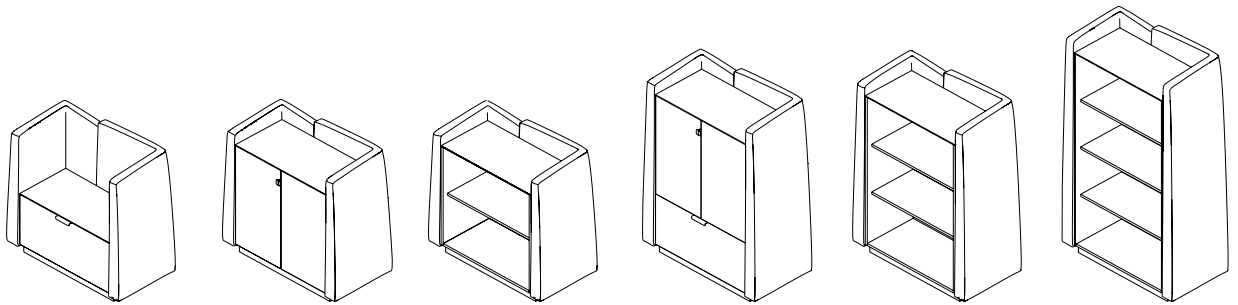

	SP-01	SP-02	SP-03	SP-04	SP-05	SP-06
height	490 + 559	880 + 175	880 + 175	1285 + 175	1285 + 175	1655 + 175
depth	530	530	530	530	530	530
width	940	940	940	940	940	940

interior	drawer	shelves	shelves	drawer and shelves	shelves	shelves
additional elements						
planter	YES / NO	YES / NO	YES / NO	YES / NO	YES / NO	YES / NO
acoustic panels	P-01 / P 02	P-01 / P 02	P-01 / P 02	P-03 / P 04	P-03 / P 04	P-05 / P 06



soma

Panels

Choose Your own

SOMA panels can be combined to create freestanding walls that subtly demarcate spaces, define circulation routes, and improve acoustic comfort without building permanent walls. These same panels can also be paired with cabinet modules, creating furniture with enhanced sound-absorbing properties and a completely different character: more protective and enveloping. The photo shows a cabinet enclosed in panels that simultaneously provides storage, organizes space, and creates a quiet micro-sanctuary in the office.





Panels

Standing panels, available in three heights and left- and right-handed variants, should be used in sets of at least two. They can also create a private space around the desk.

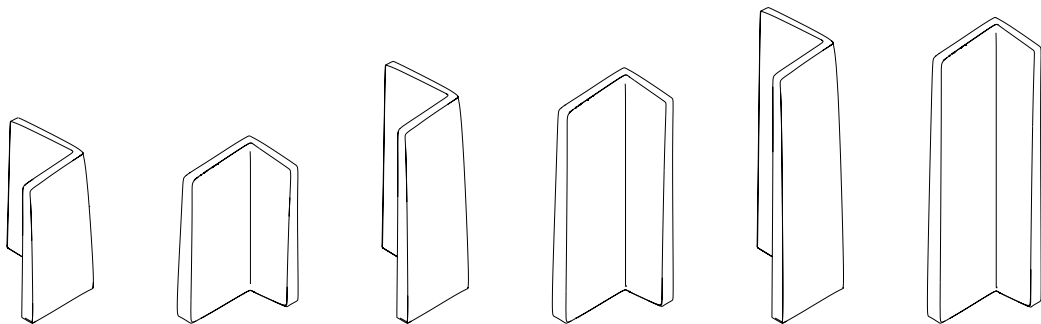

	P-01	P-02	P-03	P-04	P-05	P-06
height	975	935	1385	1335	1770	1735
depth	530	530	530	530	530	530
width	640	385	640	385	640	385

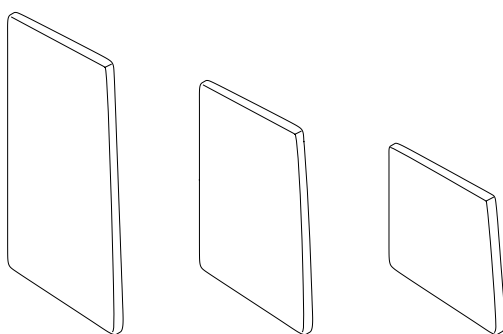

	P-07	P-08	P-09
height	1750	1350	950
depth	70	70	70
width	715	715	715



Wall screens

SOMA wall screens complete the acoustic layout of an office by absorbing sound reflections from large surfaces and visually unifying the space. They are available in two versions: a smooth, undivided version, ready for printing with graphics, wayfinding, or branding, and a version with soft divisions that introduce rhythm and subtle textures into the background. Both versions use the same fabrics and colors as the rest of the collection, making it easy to create a cohesive composition with SOMA panels and cabinets.

**Two screen versions:
PURE and SHELL**

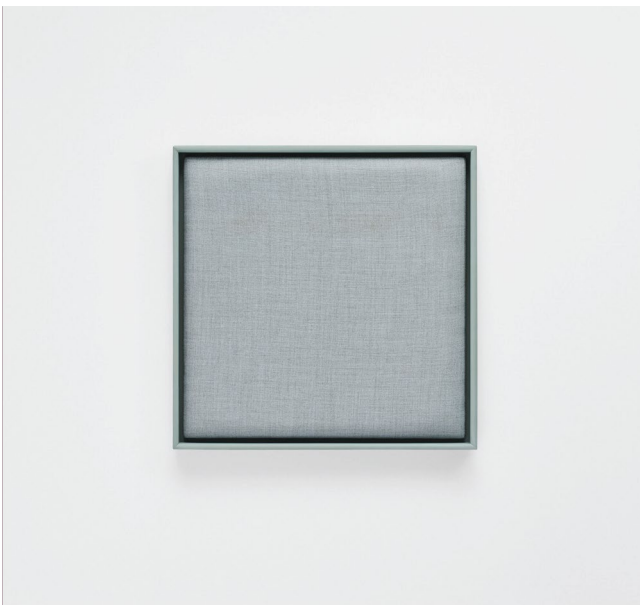



roni horn
the selected gifts, 1974-2015
RONI HORN
redesign.co.uk
2020furniture
Annis Tsarouchis: Dancing in Real Life

soma



Wall screens lightweight wall screens with acoustic properties, with the option of printing

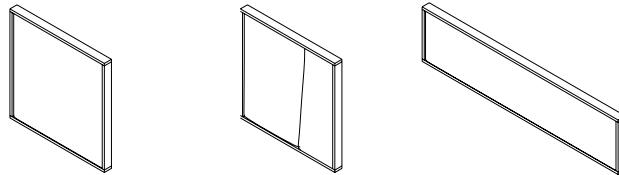

	WS-01	WS-02	WS-03
height	800	800	400
depth	60	60	60
width	800	800	1660

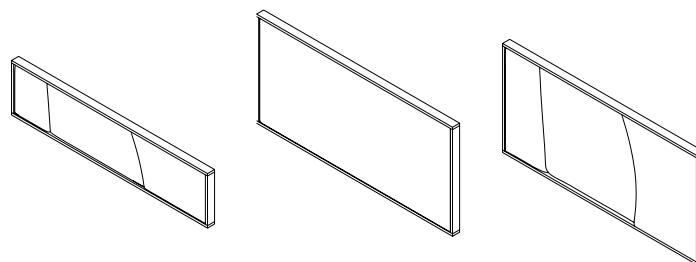

	WS-04	WS-05	WS-06
height	400	800	800
depth	60	60	60
width	1660	1660	1660

Desks

Different people concentrate differently. For some, the key to concentration is silence and stillness, while for others, it's the ability to move, change positions, and slightly "move" the body throughout the day. Therefore, **Soma** desks can be equipped with movable tops with smooth up-and-down adjustment, allowing you to transition from a sitting to a standing position in seconds and adjust the height to your current needs.

For those who work best in a more isolated environment, desks can be expanded with additional privacy panels. These create a soft, acoustic frame around the workstation, limiting eye contact, softening ambient noise, and helping you find your own island of peace in an open-plan office.

In projects where simplicity is key, SOMA desks can remain classic, stationary work tables. They stand on distinctive, upholstered legs that not only enhance the furniture's character but also absorb some sound, discreetly enhancing

**storage solutions
with acoustic
properties**





soma



Desks

Here we talk about desks that are available in the following versions: simple - non-liftable; simple desk with adjustable height and accessories supporting concentration - i.e. optional desk panels, even allowing the creation of a separate, quiet box.

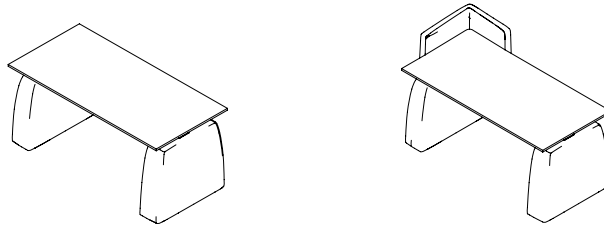

	DK-01	DK-02
height	750	750 + 300
depth	800	870
width	1660	1730
vertical adjustment	YES / NO	YES / NO

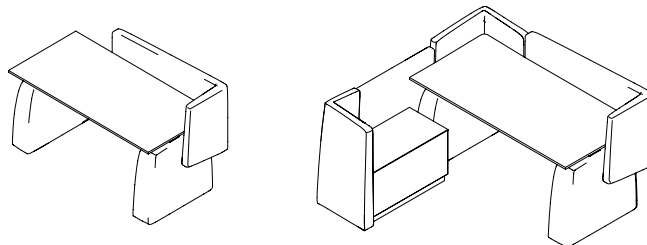

	DK-03	DK-04
height	750 + 300	750 + 300
depth	870	1740
width	1730	1800
vertical adjustment	YES / NO	YES / NO

soma



soma works within the room, smoothing out sound reflections where they occur, reducing reverberation and improving speech intelligibility. Less noise means less cognitive fatigue and more focus. The modular design grows with your team and easily adapts to changing needs.



soma

Tables

The SOMA collection is accompanied by conference tables that repeat the form language of desks - they are sparse in detail, yet designed for the intensive, everyday work of teams.

The tabletop can be configured to suit specific needs: upon request, we can equip it with modules with 230V power sockets, USB inputs for charging mobile devices, network and signal sockets (e.g. HDMI, RJ45) and cable glands that organize cables and help keep the tabletop clean and tidy.



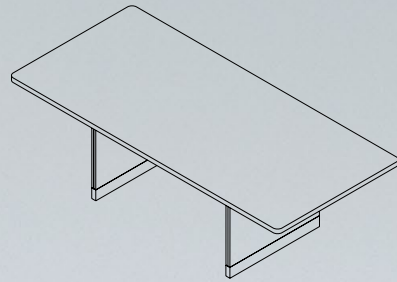

	T-01	T-02
height	500	750
depth	600	1100
width	600	2400



Fabrics & materials

Acoustics that you can feel from day one.

SOMA use porous, absorbent layers (including LDF boards) and soft textile coverings that reduce unwanted reflections from walls, countertops, and glazing. The system is designed with the human speech frequency in mind – where reverberation reduction has the greatest effect: better meetings, less background noise, and increased work comfort.

Collection

Choose Your own

By default, we offer three monochromatic finishes: **Brick, Aqua, and Cashmere**. Each includes upholstery fabrics, frames, and painted element colors, ensuring the entire interior remains visually cohesive and organized.

For larger projects, we can also prepare custom color configurations – based on the client's palette or selected fabric collections. A full catalog of our standard panels can be found on our website.

Upholstery

You can choose from 3 different colors and vibes. If You need a different color we can meet Your needs.

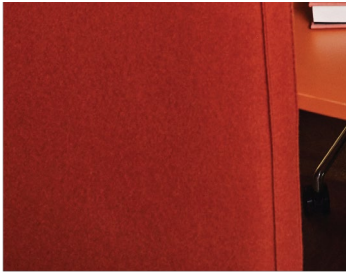

Brick



Aqua



Cashmere

Case

You can choose from 3 different colors and vibes. If You need a different color we can meet Your needs.



Brick

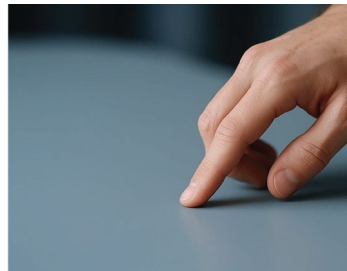

Aqua



Cashmere

Paint

You can choose from 3 different colors and vibes. If You need a different color we can meet Your needs.



Brick Close to RAL



Aqua Close to RAL

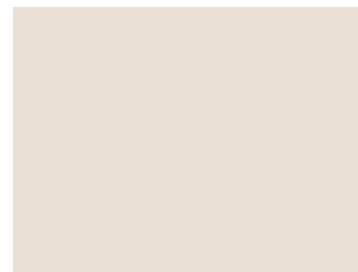



Cashmere Close to RAL



soma

Contact

 07398 891127

 sales@2020furnituredesign.co.uk

 2020furnituredesign.co.uk

  @2020furnituredesign

